

THIS COPY IS PROVIDED ON A RESTRICTED BASIS AND IS NOT TO BE USED IN ANY WAY DETRIMENTAL TO THE INTERESTS OF PANDUIT CORP.

HSTTP 12 - M

PANDUIT NUMBERING SYSTEM

LENGTH M = 1000' MIN.
 D = 500' MIN.
 TL = 250' MIN.
 C = 100' MIN.

EXPANDED I.D. TUBING SIZE.

PVC THIN WALL HEAT SHRINK TUBING.

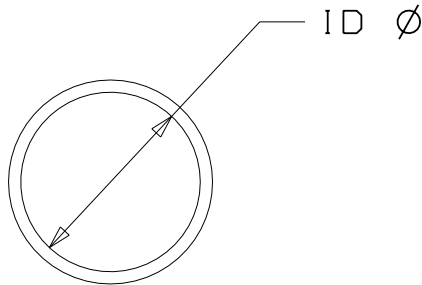

| PANDUIT PART NUMBER | Min. RECOVERED ID | Max. RECOVERED ID | NOMINAL REC WALL THICKNESS [in. (mm)] |
|---------------------|-------------------|-------------------|---------------------------------------|
| HSTTP05-M | .046 (1.2) | .023 (.6) | .020 (0.5) |
| HSTTP06-M | .063 (1.6) | .031 (.8) | .020 (0.5) |
| HSTTP09-M | .093 (2.4) | .046 (1.2) | .025 (0.6) |
| HSTTP12-M | .125 (3.2) | .062 (1.6) | .025 (0.6) |
| HSTTP19-M | .187 (4.8) | .093 (2.4) | .025 (0.6) |
| HSTTP25-M | .250 (6.4) | .125 (3.2) | .025 (0.6) |
| HSTTP38-D | .375 (9.5) | .187 (4.8) | .030 (0.8) |
| HSTTP50-D | .500 (12.7) | .250 (6.4) | .030 (0.8) |
| HSTTP75-C | .750 (19.0) | .375 (9.5) | .035 (0.9) |
| HSTTP100-TL | 1.000 (25.4) | .500 (12.7) | .040 (1.0) |
| HSTTP150-C | 1.500 (38.1) | .750 (19.0) | .045 (1.1) |
| HSTTP200-C | 2.000 (50.8) | 1.000 (25.4) | .050 (1.3) |

NOTES:

1. MATERIAL: CROSS-LINKED, FLEXIBLE, HIGHLY FLAME RETARDANT.
2. COLOR: BLACK
3. SHRINK RATIO: 2:1
4. SHRINK RATIOS ARE APPROXIMATIONS; PLEASE REFER TO DIMENSIONAL TABLE FOR THE EXACT MINIMUM EXPANDED AND MAXIMUM RECOVERED I.D.'S
5. "ALL WARRANTIES, INCLUDING MERCHANTABILITY AND FITNESS FOR A PARTICULAR PURPOSE, ARE EXCLUDED. (USER IS RESPONSIBLE TO DETERMINE SUITABILITY OF PRODUCT FOR INTENDED USE.)"

| | |
|---|---|
| DIMENSIONS IN BRACKETS ARE METRIC [mm] | |
| CAD FILENAME/LAYERS G00239K1_PB_HSTTP_01 | |
| | |
| HSTTP PVC THIN WALL HEAT SHRINK | |
| UNLESS OTHERWISE SPECIFIED, DIMENSIONAL TOLERANCES ARE: (.X) ±0.05 (1.3) (.XXX) ±0.010 (0.25) (.XX) ±0.02 (0.5) ANGLES ± 5° | UNLESS OTHERWISE SPECIFIED, ALL DIMENSIONS ARE GIVEN IN INCHES, THIRD ANGLE PROJECTION. |
| DRAWN BY LGRAVITT | MAT'L: |
| DATE 5/12/03 | SEE NOTES |
| CHK'D | SCALE NONE |
| | DRAWING NO. G00239K1 |
| | DWG SIZE A |

| REV | DATE | BY | CHK | DESCRIPTION | ECN | R | CUST | SUP |
|-----|---------|-----|-----|--------------------------|----------|---|------|-----|
| 1 | 2/23/06 | JAD | | HSTTP75-C WAS HSTTP75-TL | GB0239K1 | 1 | | |